

### NEOPRENE CAPS

Slip on the heads of hex-head spindles.

Durometer: 60-70.

Normal operating range: -40° F to 220° F.

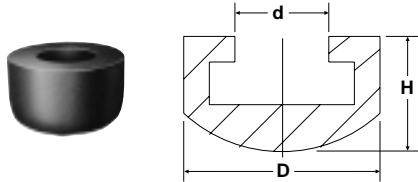

Part No.	EDP No.	D	d	H	For Spindle Diameter
225108	59101	0.61	0.31	0.38	1/4
215119	59102	0.63	0.25	0.44	1/4
225119	59103	0.75	0.31	0.50	5/16
235119	59105	0.78	0.38	0.53	3/8

### SPECIAL NEOPRENE CAPS

Slip on threaded spindle rod.

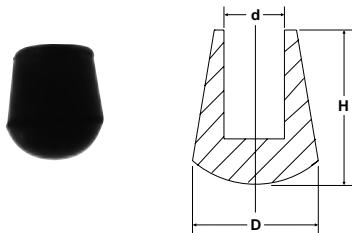

Part No.	EDP No.	D	d	H	For Spindle Diameter
424107	59106	0.44	0.22	0.44	7/32
235110	59104	0.72	0.34	0.88	11/32

### POLYURETHANE CAPS

Flat-Tip, internally threaded to screw onto spindle end. Durometer: 80.

Normal operating range: -90° F to 250° F.

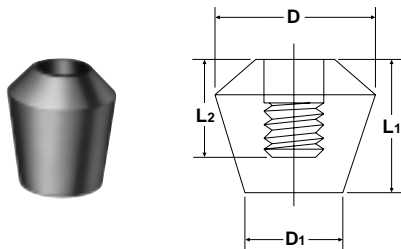

Part No.	EDP No.	D	D <sub>1</sub>	L <sub>1</sub>	L <sub>2</sub>	For Spindle Diameter
215219	59110	0.81	0.50	0.69	0.50	1/4
225219	59111	0.81	0.50	0.69	0.50	5/16
235219	59112	0.81	0.63	0.88	0.63	3/8

### POLYURETHANE CAPS

Cone-Tip, internally threaded to screw onto spindle end.

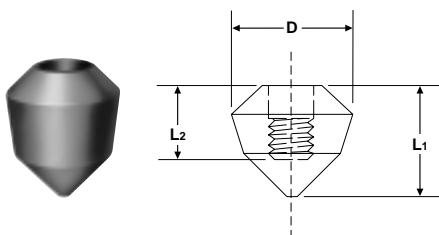

Part No.	EDP No.	D	L <sub>1</sub>	L <sub>2</sub>	Point Angle	For Spindle Diameter
215319	59113	0.81	0.75	0.50	90°	1/4
225319	59114	0.81	0.75	0.50	90°	5/16
235319	59115	0.81	0.94	0.63	90°	3/8