

Model 610 straight-line action clamps are widely used for gluing applications in the woodworking industry. The customer can add spindle pads to permit using full clamping force without damaging the wood.

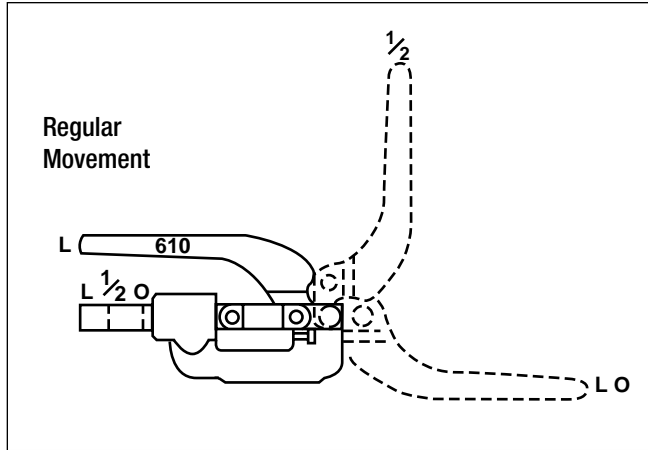

Plunger moves forward and locks as handle is moved forward. Plunger also locks in retracted position when handle is moved backwards

**STATUS OF HANDLE AND BAR**  
**L = Locked O = Opened 1/2 = Intermediate Position**

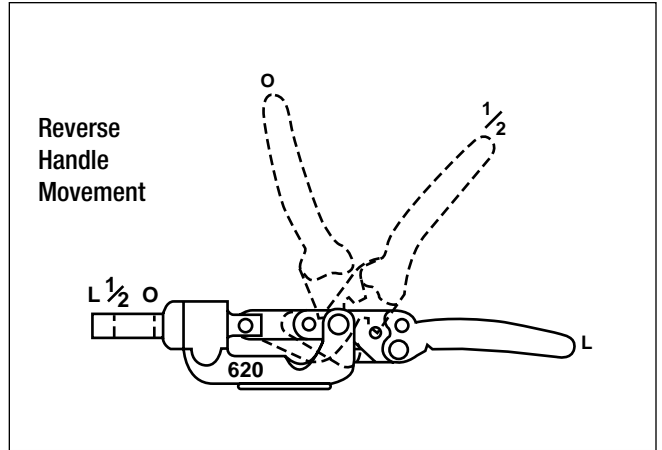

Plunger moves forward and locks as handle is moved backward to horizontal position. Plunger retracts as handle is moved forward but does not lock in retracted position.

## MODELS 601, 601-O

Smallest of the straight-line toggle clamps. Ideal for electronic applications and similar small fixturing. Model 601 has an 8-32 nylon spindle assembly (105203). Model 601-O has externally threaded 1/4-20 plunger tip. Red handle grip is supplied on all non-stainless steel models. Metric Plunger available with M4 internal thread.

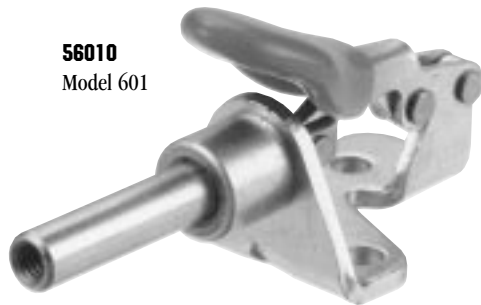

**56010**  
Model 601



**56016**  
Model 601-O

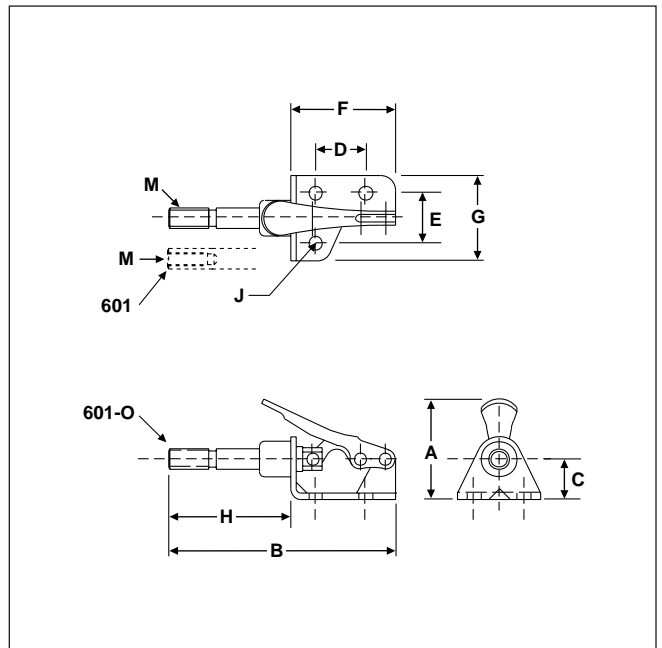

**ALSO AVAILABLE**

As Air/Hydraulic	<b>Model 816</b>	<b>Page 111</b>
In Stainless Steel	<b>Models 601-OSS, 601-SS</b>	<b>Page 67</b>
With Metric Plunger	<b>Model 601-M</b>	<b>Page 68</b>

Model No.	EDP No.	Holding Capacity	Weight	Plunger Travel	Plunger Thread	Dimensions									
						A	B	C	D	E	F	G	H	J	M
601	56010	100 lbs.	.09 lbs.	.63"	8-32	1.19	2.59	.50	.63	.63	1.31	1.05	1.28	.17	8-32
601-O	56016	100 lbs.	.13 lbs.	.63"	1/4-20	1.19	2.84	.50	.63	.63	1.31	1.05	1.53	.17	1/4-20