

MANUAL CLAMPS

Hold-Down Action



SERIES 205

The smallest of the horizontal handle, horizontal bar clamps. Supplied with nylon spindle assembly (105203). Flanged washers (105106) supplied with "U" bar models. Stainless steel models supplied with stainless steel hex-head spindle assembly (205943). Handle grip supplied on the non-stainless clamps only.



52050
Model 205-U
"U" Bar
Flanged Base

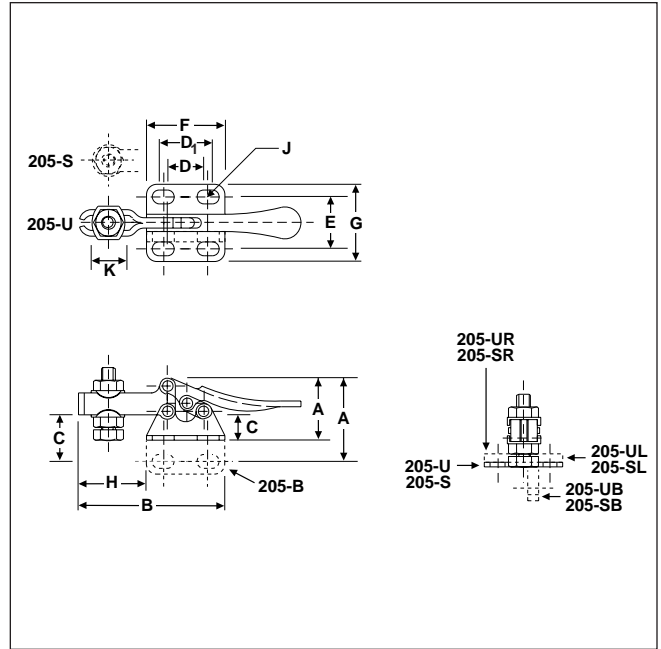

52060
Model 205-S
Solid Bar
Flanged Base



52062
Model 205-SB
Solid Bar
Straight Base



52066
Model 205-SL
Solid Bar
Left Flanged Base



52065
Model 205-SR
Solid Bar
Right Flanged Base



52052
Model 205-UB
"U" Bar
Straight Base

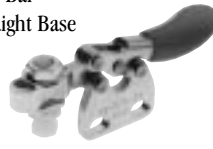

52056
Model 205-UL
"U" Bar
Left Flanged Base



52055
Model 205-UR
"U" Bar
Right Flanged Base



ALSO AVAILABLE

In Stainless Steel Model 205-SBSS Page 67
Model 205-UBSS Page 67
Model 205-SSS Page 67
Model 205-USS Page 67

Model No.	EDP No.	Holding Capacity	Weight	Handle Moves	Bar Opens	Dimensions										
						A	B	C	D	D ₁	E	F	G	H	J / SLOT	K
205-S	52060	60 lbs.	.06 lbs.	80°	90°	.72	2.75	.41	.44	.63	.63	.94	.94	.83	.17 x .27	—
205-SB	52062	60 lbs.	.06 lbs.	80°	90°	.84	2.75	.63	.44	.63	—	.94	—	.83	.17 x .27	—
205-SL	52066	60 lbs.	.06 lbs.	80°	90°	.72	2.75	.41	.44	.63	—	.94	—	.83	.17 x .27	—
205-SR	52065	60 lbs.	.06 lbs.	80°	90°	.72	2.75	.41	.44	.63	—	.94	—	.83	.17 x .27	—
205-U	52050	60 lbs.	.06 lbs.	80°	90°	.72	2.66	.31	.44	.63	.63	.94	.94	.69	.17 x .27	.38
205-UB	52052	60 lbs.	.06 lbs.	80°	90°	.84	2.66	.53	.44	.63	—	.94	—	.69	.17 x .27	.38
205-UL	52056	60 lbs.	.06 lbs.	80°	90°	.72	2.66	.31	.44	.63	—	.94	—	.69	.17 x .27	.38
205-UR	52055	60 lbs.	.06 lbs.	80°	90°	.72	2.66	.31	.44	.63	—	.94	—	.69	.17 x .27	.38